

# The Shops at Pickering City Centre

1355 Kingston Rd, Pickering, ON L1V 1B8

**Petr Kafka**  
Principal, Leasing | Salesperson  
pkafka@salthillcapital.com | 416.642.6032

**Stephen Yu**  
Senior Director, Leasing | Salesperson  
D: 416.646.7358 | syu@salthillcapital.com



## Highlights

A unique opportunity to get in at the "ground floor" of one of the largest masterplan communities in Canada. Join a growing list of national retailers at The Shops at Pickering City Centre and become a cornerstone of the new downtown Pickering. The best part - with 10+ mixed-use towers and 6,000+ new residences coming to Pickering City Centre, retailers will have immediate access to 10,000+ future customers.

- Anchored by Farm Boy, Cineplex, Hudson's Bay, H&M, Winners/HomeSense, Saks Off 5th, Shoppers Drug Mart, Dollarama and more.
- The City of Pickering's current population stands at 100,000 people and is expected to grow by over 50% over the next 15 years.

## Community Hub

Salthill developed the Community Hub program to create memorable experiences and support our local communities. The Spot is one of the three pillars that make up the Hub and is a community-inspired room available to organizations interested in hosting activities, workshops, group classes and more. The Shops at Pickering City Centre welcomes groups from Pickering and surrounding communities to utilize the space, as well as space throughout our common areas, driving further traffic to the Centre.

## Demographics | 10km Radius

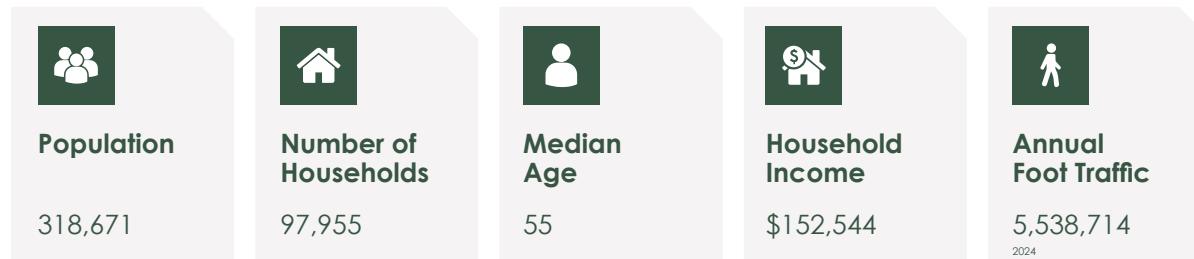

\*Data from 2023 Environics Analytics.



SEPHORA



# The Shops at Pickering City Centre

1355 Kingston Rd, Pickering, ON L1V 1B8

**Petr Kafka**  
Principal, Leasing | Salesperson  
pkafka@salthillcapital.com | 416.642.6032

**Stephen Yu**  
Senior Director, Leasing | Salesperson  
D: 416.646.7358 | syu@salthillcapital.com

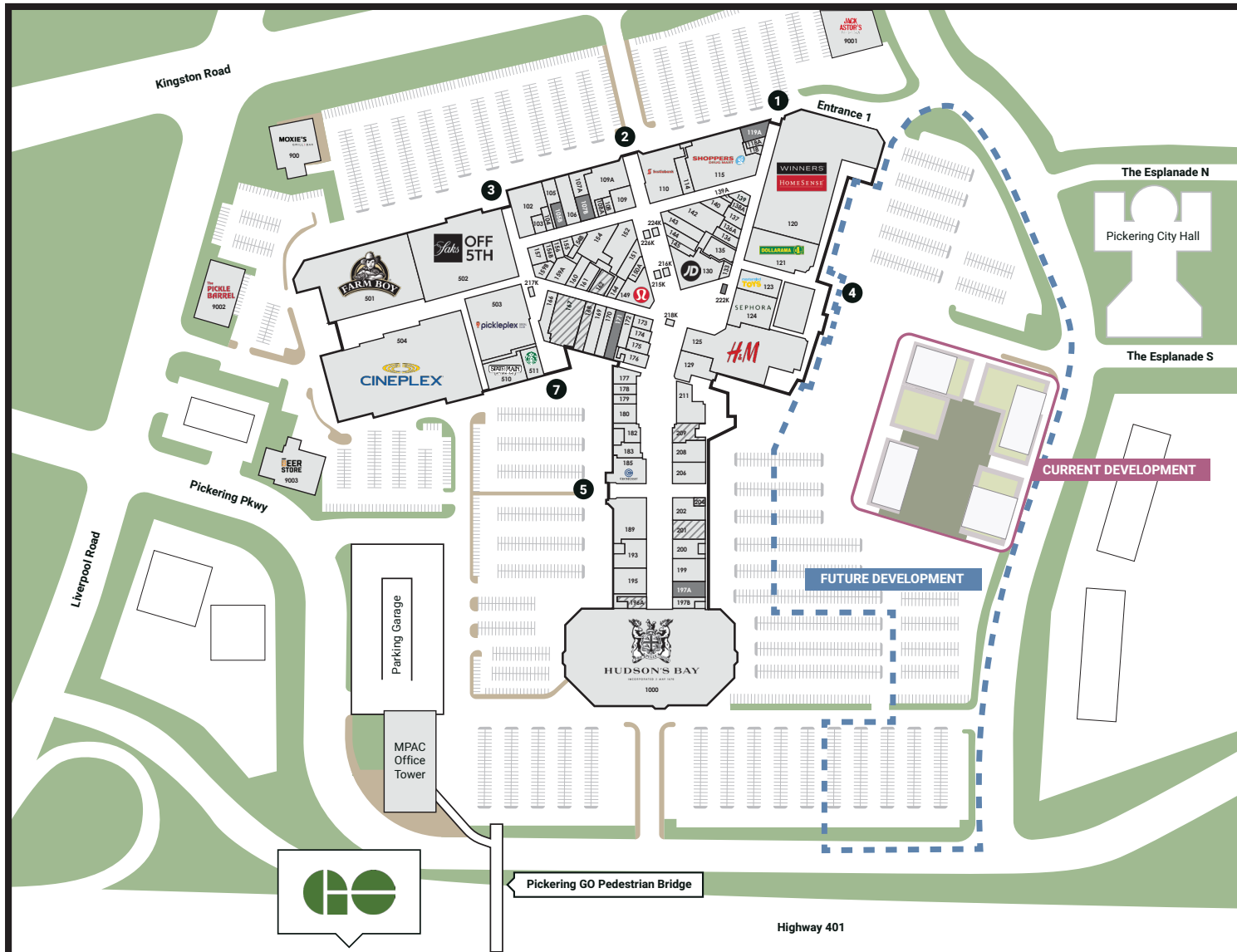

- 102. East Side Mario's (5,617 SF)
- 103. Island Ink-Jet (967 SF)
- 104. The Barber Shop (752 SF)
- 105. Burger Priest (1,400 SF)
- 105B. Available (1,149 SF)
- 106. Lenscrafters (2,874 SF)
- 107A. Dave's Hot Chicken (2,200 SF)
- 107B. Available (1,156 SF)
- 108. Wireless + (686 SF)
- 108A. Caryl Baker (581 SF)
- 109. Peoples (2,115 SF)
- 109A. Carter's/Oshkosh (5,220 SF)
- 110. Scotiabank (8,125 SF)
- 114. L'attitudes (1,590 SF)
- 115. Shoppers Drug Mart (13,103 SF)
- 118. T-shirt Arcade (554 SF)
- 118A. Akrilix Nails (562 SF)
- 119A. Available (1,646 SF)
- 120. Winners/Homesense (42,126 SF)
- 121. Dollarama (10,469 SF)
- 123. Mastermind (3,387 SF)
- 124. Sephora (5,911 SF)
- 125. H&M (20,102 SF)
- 129. La Vie En Rose (3,727 SF)
- 130. JD Sports (5,870 SF)
- 133. Dia Amore (535 SF)
- 135. Pearle Vision (1,915 SF)
- 136. Reeds Florist (1,073 SF)
- 136A. Trade Secrets (853 SF)
- 137. Famous Optical (1,231 SF)
- 138A. Stitch It (632 SF)
- 139. Booster Juice (820 SF)
- 139A. Cellpoint (353 SF)
- 140. Cameo Fashions (1,310 SF)
- 142. Sirens (4,046 SF)
- 143. Roots (2,248 SF)
- 144. EB Games (1,260 SF)
- 145. Continental Currency Exchange (826 SF)
- 149. Lululemon Athletica (3,214 SF)
- 150A. Pandora (826 SF)
- 151. Telus (1,847 SF)
- 152. Childrens Place (4,278 SF)
- 154. Cole's (4,124 SF)
- 154B. Marlin Travel (935 SF)
- 155. Laura Secord (744 SF)
- 156. Cell Tel (532 SF)
- 156B. The Sports Collection (622 SF)
- 157. Smoker's Corner (1,090 SF)
- 159A. Suzy Shier (2,249 SF)
- 159B. COCOA (1,068 SF)
- 160. Showcase (1,607 SF)
- 161. Perfume Elegance (1,349 SF)
- 162. J'Adore (1,546 SF)
- 164. My Pops (864 SF)
- 166. Women's Fitness (15,001 SF)
- 167. Sumo Dino Claw (6,161 SF)
- 168. Shop 404 (2,041 SF)
- 169. Smartech (2,026 SF)
- 170. NGR Cuts (2,385 SF)
- 171. Available (2,069 SF)
- 172. Connect Hearing (1,234 SF)
- 173. Swarovski (999 SF)
- 174. Michael Hill (1,004 SF)
- 175. Gatsby Salon & Spa (1,248 SF)
- 176. Aldo (1,497 SF)
- 177. Hakim Optical (1,605 SF)
- 178. Lush (904 SF)
- 179. Can. Owned Black Market-place (904 SF)
- 180. Specsavers (1,818 SF)
- 182. Mondano Shoes (1,536 SF)
- 183. Anna Bella (1,666 SF)
- 185. Sales Office (3,745 SF)
- 189. Bluenotes (5,824 SF)
- 193. Urban Kids (3,434 SF)
- 195. Sunrise Records (3,585 SF)
- 196A. H&R Block (1,203 SF)
- 197A. Available (2,274 SF)
- 197B. Maritime Travel (1,411 SF)
- 199. Tip Top Tailors (3,152 SF)
- 200. Exception Luggage (2,429 SF)
- 201. Mastermind (2,727 SF)
- 202. Soft Moc (2,712 SF)
- 204. Eminence Crystals (350 SF)
- 206. Tristan (3,066 SF)
- 208. Garage (2,852 SF)
- 209. Just Cozy (1,927 SF)
- 211. Reitmans (3,871 SF)
- 501. Farm Boy (30,557 SF)
- 502. Saks Off Fifth Ave (30,033 SF)
- 503. PicklePlex (18,242 SF)
- 504. Cineplex (47,064 SF)
- 510. State & Main (4,574 SF)
- 511. Starbucks (2,216 SF)
- 900. Moxies (5,536 SF)
- 9001. Jack Astors (7,698 SF)
- 9002. The Pickle Barrel (8,871 SF)
- 9003. The Beer Store (6,784 SF)
- 215K. Wirelesswave (186 SF)
- 216K. Freshly Squeezed (179 SF)
- 217K. Cellular X (120 SF)
- 218K. WOW Mobile (150 SF)
- 222K. Available (200 SF)
- 224K. TBooth (188 SF)
- 226K. Freedom Mobile (120 SF)

# The Shops at Pickering City Centre

1355 Kingston Rd, Pickering, ON L1V 1B8

**Petr Kafka**  
Principal, Leasing | Salesperson  
pkafka@salthillcapital.com | 416.642.6032

**Stephen Yu**  
Senior Director, Leasing | Salesperson  
D: 416.646.7358 | syu@salthillcapital.com

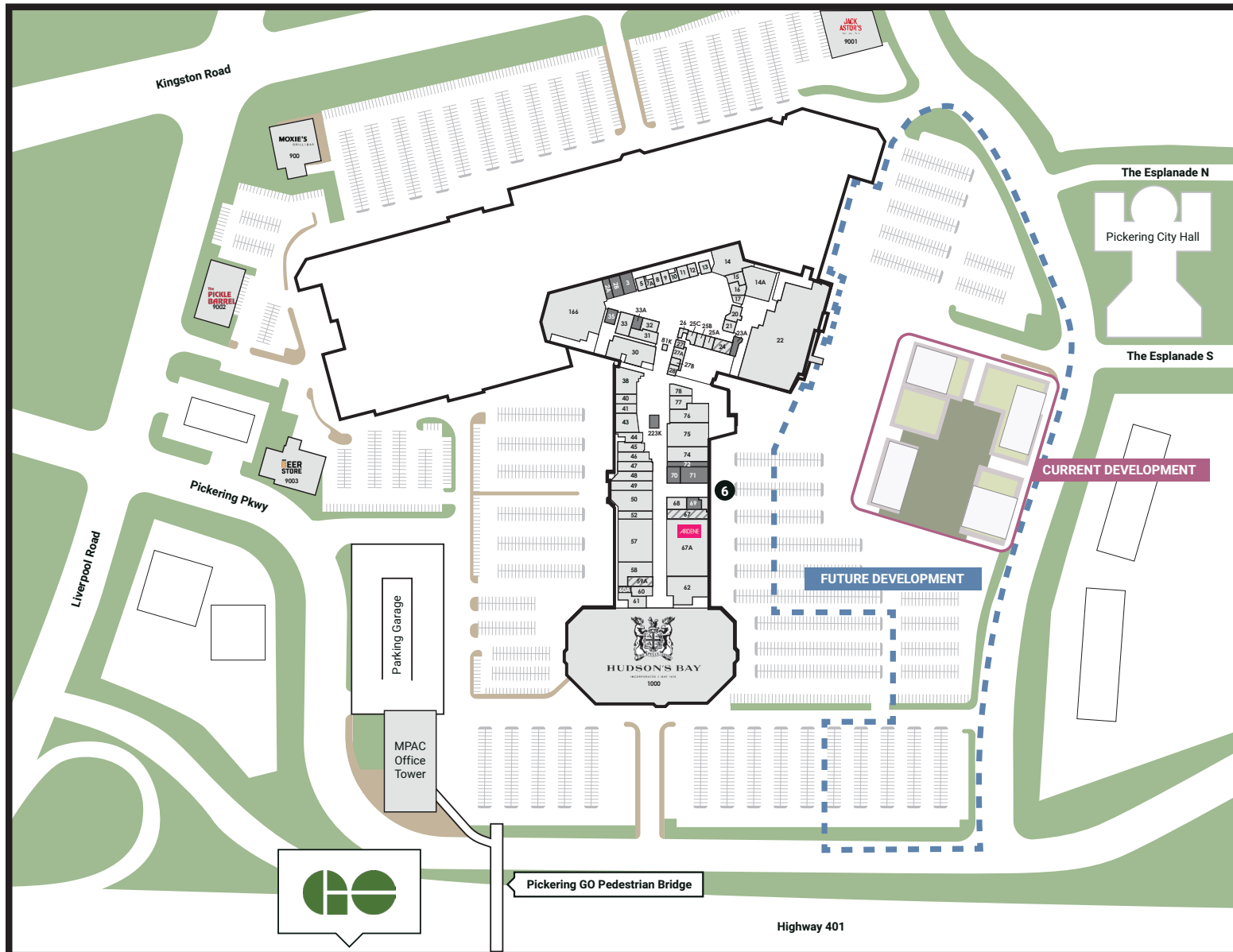

- 2A. Available (955 SF)
- 2B. Available (575 SF)
- 3. Available (1,162 SF)
- 5. Pide and Spice (499 SF)
- 7A. Edo Japan (349 SF)
- 8. A&W (440 SF)
- 9. Manchu Wok (423 SF)
- 10. Imperfect Fresh Eats (400 SF)
- 11. Bourbon Street Grill (516 SF)
- 12. Jimmy The Greek (544 SF)
- 13. Popeyes (572 SF)
- 14. Pickering Dental (3,902 SF)
- 14A. Region of Durham (3,584 SF)
- 15. Taco Bell (500 SF)
- 16. New York Fries (300 SF)
- 17. Subway (407 SF)
- 20. Tim Hortons (816 SF)
- 21. Chatr Mobile (478 SF)
- 22. Available (41,011 SF)
- 22M. Available (2,614 SF)
- 23A. Guest Services (627 SF)
- 24. Elegance Beauty Lounge and Academy (949 SF)
- 25A. Bang Bang (465 SF)
- 25B. Thai Express (460 SF)
- 25C. Caribbean Hotpot (475 SF)
- 26. Kernels (248 SF)
- 27. Lids (312 SF)
- 27A. Garo Jewellers (540 SF)
- 27B. Mobile Klinik (261 SF)
- 28. Real Fruit Bubble Tea (369 SF)
- 30. Footlocker (4,528 SF)
- 31. Tonic (828 SF)
- 32. Rocky Mountain Chocolate (880 SF)
- 33. Security Office (1,640 SF)
- 33A. Available (447 SF)
- 35. Available (630 SF)
- 38. West 49 (2,885 SF)
- 40. Claire's (904 SF)
- 41. Exotic Knocks (909 SF)
- 43. B. Casual (1,923 SF)
- 44. Sunglass Hut (926 SF)
- 45. Hayal Boutique (1,094 SF)
- 46. Rogers Wireless (1,417 SF)
- 47. Bell (1,455 SF)
- 48. Artistic Homeware (1,513 SF)
- 49. Zack's (1,714 SF)
- 50. Bootlegger (3,475 SF)
- 52. Signor Angelo (1,228 SF)
- 57. Laura (6,500 SF)
- 58. Northern Reflections (2,772 SF)
- 59A. Liberty Tax (957 SF)
- 60. CellularX (891 SF)
- 60A. Available (485 SF)
- 61. Dr. Herman Tong (1,397 SF)
- 62. Labels (4,275 SF)
- 67. Calendar Club (1,712 SF)
- 67A. Ardene (10,431 SF)
- 68. Body Shop (1,024 SF)
- 69. Available (736 SF)
- 70. Available (444 SF)
- 71. Available (1,998 SF)
- 72. Available (901 SF)
- 74. Jason Jackson (2,734 SF)
- 75. Fairweather (4,265 SF)
- 76. Bath & Body Works (2,968 SF)
- 77. Bentley (1,197 SF)
- 78. Best Buy Mobile (940 SF)
- 81K. Virgin Mobile (150 SF)
- 223K. Available (145 SF)